

Small High Power Relay

KKK-102F

- .. Can be welded directly onto PCB.
- Used in household appliance like air conditioner
- Conditioning, heater and instruments etc.
- Size; 30.5*16*23.5

KKK



30.5*16.0*23.5

CONTACT DATA

Contact Form 触点形式	1A	
Contact Material 触点材料	Ag•SnO ₂	
Contact Ratings 触点负载	25A/277VAC (resistive) 1.5HP/125V 1.5HP/250V TV-10/120V inrush current: 80A 250VAC COS θ 0.7	
Max Switching Power 最大转换功率	6925VA	
Max Switching Voltage 最大转换电压	300VAC Max. Switching Current: 25A	
Operation life 寿命	Electrical 电气	Electrical 电气寿命: 100,000 Operations (at 30 Operations/minute)
	Mechanical 机械	Mechanical 机械寿命: 10,000,000 Operations (at 300 Operations/minute)

COIL PARAMETER 线圈参数

Coil voltage (VDC) 线圈电压		Coil resistance ($\Omega \pm 10\%$) 线圈电阻	Pickup voltage (max) (VDC) (75% of rated voltage) 最大吸合电压	release voltage (min) (VDC) (10% of rated voltage) 最小释放电压	Coil power consumption (W) 功率	Operate Time (ms) 吸合时间	Release Time (ms) 释放时间
Rated	Max.						
3	3.9	10	2.25	0.3	0.9	≤ 20	≤ 10
5	6.5	27.8	3.75	0.5			
6	7.8	40	4.5	0.6			
9	11.7	90	6.75	0.9			
12	15.6	160	9.0	1.2			
24	31.2	640	18	2.4			
48	62.4	2560	36	4.8			

CAUTION: 1. The use of any coil voltage less than the rated coil voltage will compromise the operation of the relay.
2. Pickup and release voltage are for test purposes only and are not to be used as design criteria.

OPERATION CONDITION

Insulation Resistance 绝缘阻值	100M Ω min (at 500VDC)
Dielectric Strength 耐压 Between contacts 触点间 contact and coil 线圈间	50Hz 1500V 50Hz 4500V surge voltage: 10kV
Shock resistance 抗冲击性	Functional: 100m/s ² 11ms Endurance: 1000 m/s ² 11ms
Vibration resistance 抗共振	10~55Hz double amplitude Functional 1.5mm double amplitude Endurance 2.0mm
Terminals strength 终端强度	10N 8N
Solder ability 焊料能力	250 $^{\circ}$ C \pm 2 $^{\circ}$ C 3 \pm 0.5s
Ambient Temperature 环境温度	-40 ~ +85 $^{\circ}$ C
Relative Humidity 湿度	20~85%
Weight 重量	28g

ENGINEERING DATA 设计参数

最大切换功率

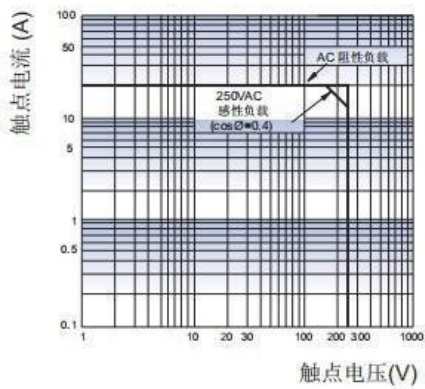

电耐久性曲线

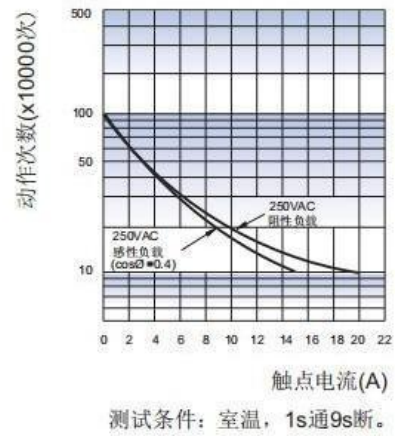

DIMENSIONS (UNIT: MM)

Standard Type (PCB & QC)

(PCB)

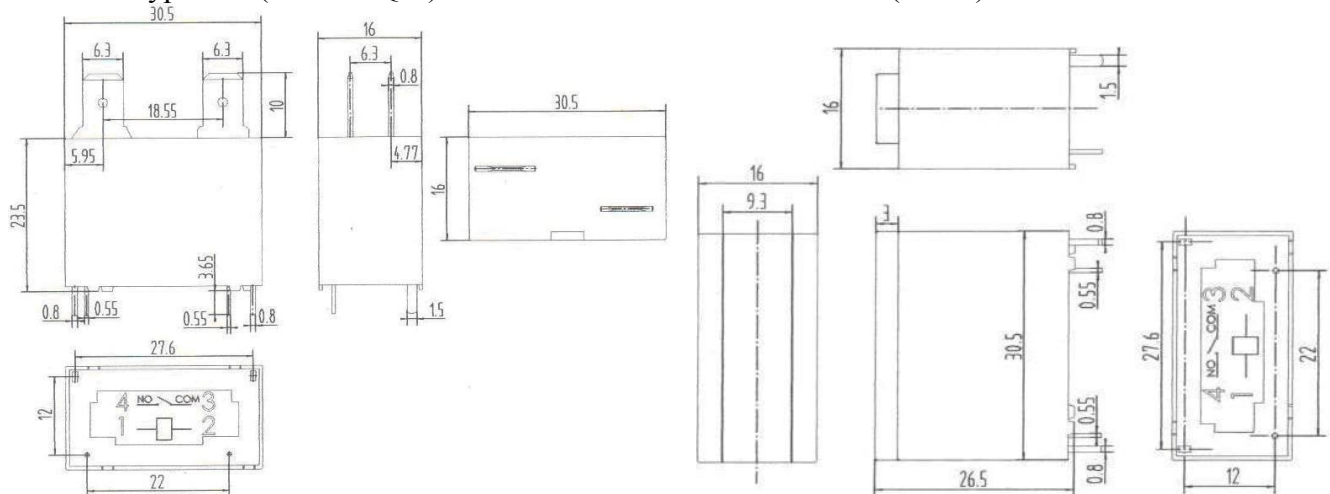

(Bracket cover)

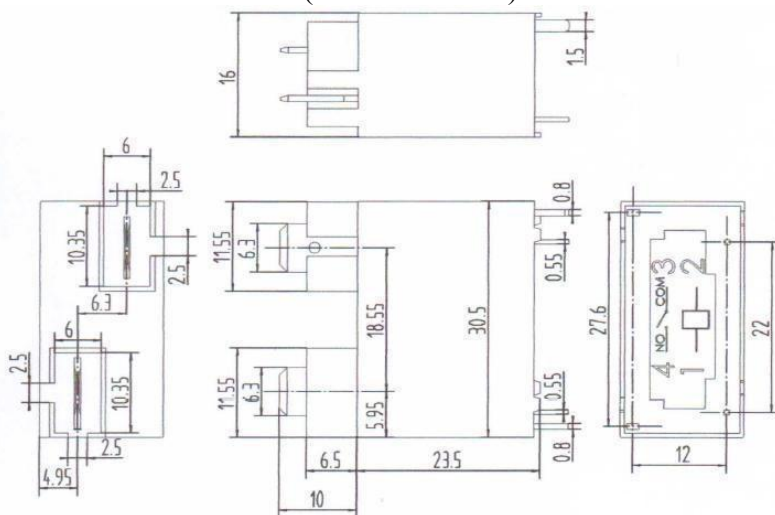

Dimensions

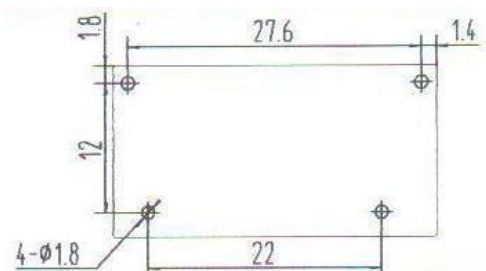

Mounting (Bottom views)

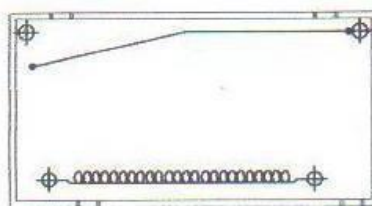

Wiring diagram (Bottom views)

外形图

HF102F

HF102F-P

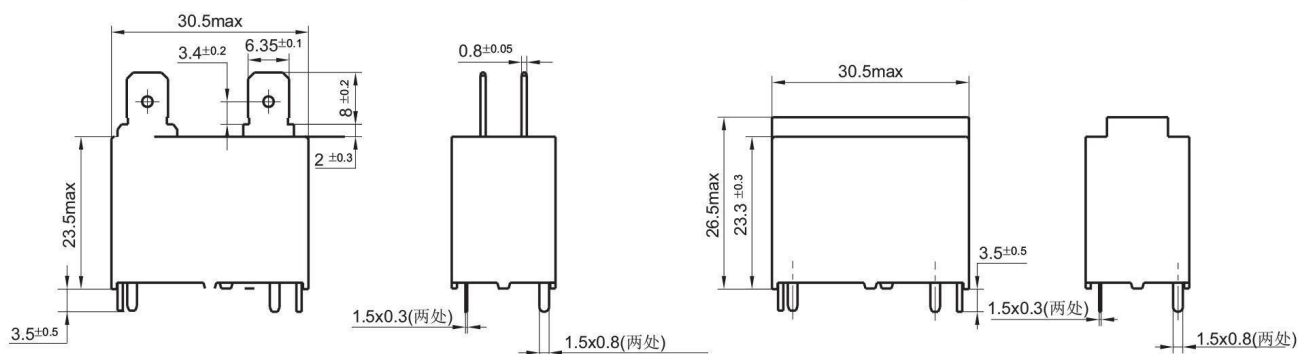

(俯视图)

(俯视图)

安装孔尺寸(底视图)

接线图

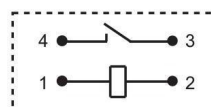
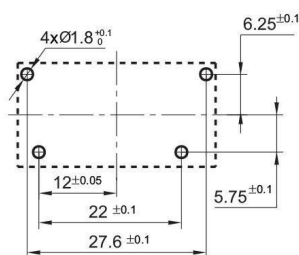

备注：(1) 产品外形图的引脚标注尺寸为沾锡前尺寸(沾锡后会变大)，安装孔尺寸为推荐的PCB板孔的设计尺寸，具体PCB板孔设计尺寸可根据产品实物进行测绘、调整；

(2) 产品部分外形尺寸未注尺寸公差，当外形尺寸 $\leq 1\text{mm}$ ，公差为 $\pm 0.2\text{mm}$ ；当外形尺寸在 $(1 \sim 5)\text{mm}$ 之间时，公差为 $\pm 0.3\text{mm}$ ；当外形尺寸 $> 5\text{mm}$ ，公差为 $\pm 0.4\text{mm}$ ；

(3) 安装孔尺寸中未注尺寸公差为 $\pm 0.1\text{mm}$ 。